

AL003 TILT-N-TOTE



INSTALLATION/ OWNER'S MANUAL



TABLE OF CONTENTS

- SAFETY** 4
 - Safety Definitions 4
- INTRODUCTION** 5
 - Device Name: AL003 5
 - Read and Understand 5
 - Technical Specifications 5
- PREPARATION** 6
 - Unboxing 6
- INSTALLATION** 7
 - Ball Mount and Hitch Adapter Installation 7
 - Hold-Down Arm Installation 8
- OPERATION** 9
 - Loading Wheelchair 9
 - Unloading Wheelchair 11
 - Tilt Away Feature 13
- MAINTENANCE** 14
- TROUBLESHOOTING** 15
- WARRANTY** 16

SAFETY

SECTION 1

SAFETY**SAFETY DEFINITIONS**

This safety alert symbol appears with safety statements. It means attention, become alert, your safety and the safety of others are involved! Please read and abide by the message that follows the safety alert symbol.

 **WARNING**

Indicates a hazardous situation that, if not avoided, could result in death or serious injury.

 **CAUTION**

Indicates a hazardous situation that, if not avoided, could result in minor or moderate injury.

NOTICE

Indicates a situation which can cause damage to the lift and/or the environment, or cause the lift to operate improperly.

NOTE: Indicates a condition that should be followed in order for the lift to function in the manner intended.

If you do not understand any portion of the installation or operation procedures, please consult Harmor's LiftSquad Support at 800-833-0478. Do not attempt to install or use this lift if you have any hesitation or question. Serious injury or damage can result if proper procedures are not followed.

- **Caution:** Keep hands away from pinch points.
- Inspect the condition of the AL003 often. If any parts are worn or damaged **DO NOT USE THE AL003**. Immediately contact your Harmor authorized dealer.
- **Caution:** Keep hands, feet and any objects away from the platform as it lowers.
- **Caution:** Before driving off with the wheelchair on the AL003, make sure that the wheelchair is firmly held down on the platform.
- **Caution:** When driving with the wheelchair on the AL003, slow down for potholes, speed bumps, railroad tracks, etc. The AL003 could be damaged by abuse if subjected to excessive loads imposed by rough driving.
- **Caution:** Do not enter steep driveways straight on. Enter and leave at an angle to the street so that the AL003 platform does not drag on the ground.
- **Caution:** Do not attempt to move the vehicle with the AL003 platform in the tilted down position. If moved this way, the platform, lift, and/or vehicle can be damaged.
- **Hand-wash or only use a touch-less automatic car wash with the lift installed.** To prevent damage **DO NOT** use automatic car wash systems.



SECTION 2

INTRODUCTION

DEVICE NAME: AL003

Indications of Use: The intended use of the AL003 is to lift, secure and transport an unoccupied folded manual wheelchair for patients or mobility-impaired persons.

READ AND UNDERSTAND

Read and understand this manual prior to installation. Having an overall understanding of the lift and proper installation techniques will help save time, energy and avoid possible injury.

This manual provides instructions for proper installation and operation of an AL003. Be sure to provide the Installation/Owner's Manual to the owner of the lift before it is put into service. Any alterations to the equipment without written authorization by the manufacturer may void the warranty.

TECHNICAL SPECIFICATIONS

Visit harmar.com for specifications on the specific lift model and configuration.

SECTION 3 **PREPARATION**

The AL003 is packaged with a ball mount and stabilizer. If a Class 1, 2, 3, or 5 hitch adapter is required, it has to be ordered separately.

Be sure and check the contents of the box against the package checklist to be sure that all parts are included for proper installation. If any parts are missing or damaged, immediately contact the distributor from which you purchased your lift.

WARNING

DO NOT attempt to install or use the lift with any missing or damaged parts.

UNBOXING

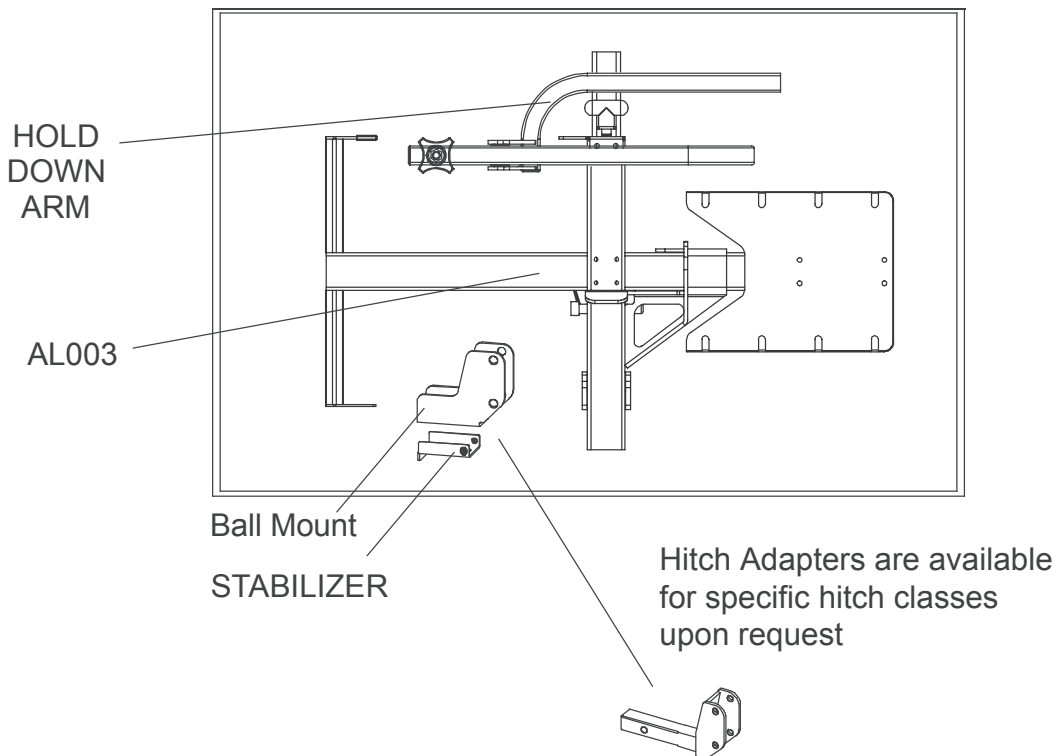

SECTION 4
INSTALLATION

BALL MOUNT AND HITCH ADAPTER INSTALLATION

⚠ WARNING



Do not attach the AL003 ball mount from underneath the flat hitch bar

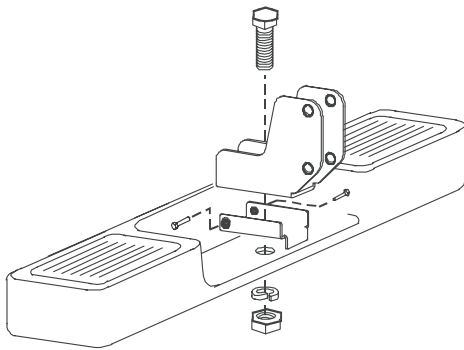

NOTICE

Be sure to comply with the vehicle's bumper rating

Refer to Figure 4-2 for proper orientation of the ball mount and to determine the flat hitch bars height from the ground. The ideal mounting height is 8" - 12" from the ground to the bottom of the flat hitch bar, while not exceeding 45° of tilt (12" off the ground). To achieve this, a number of mounting options are available.

- Flat Hitch Bar

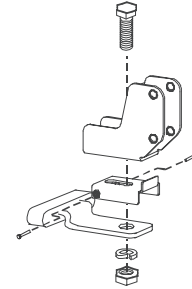

- Flat Hitch Bar with Ball Mount inverted and Stabilizer omitted

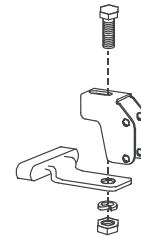

- Class 1 or 2: Solid Bar Hitch Adapter

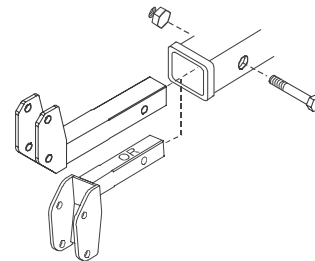

- Class 3 or 5: Tube Hitch Adapter

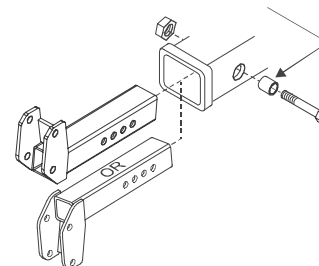

AL003: SECTION 4 INSTALLATION

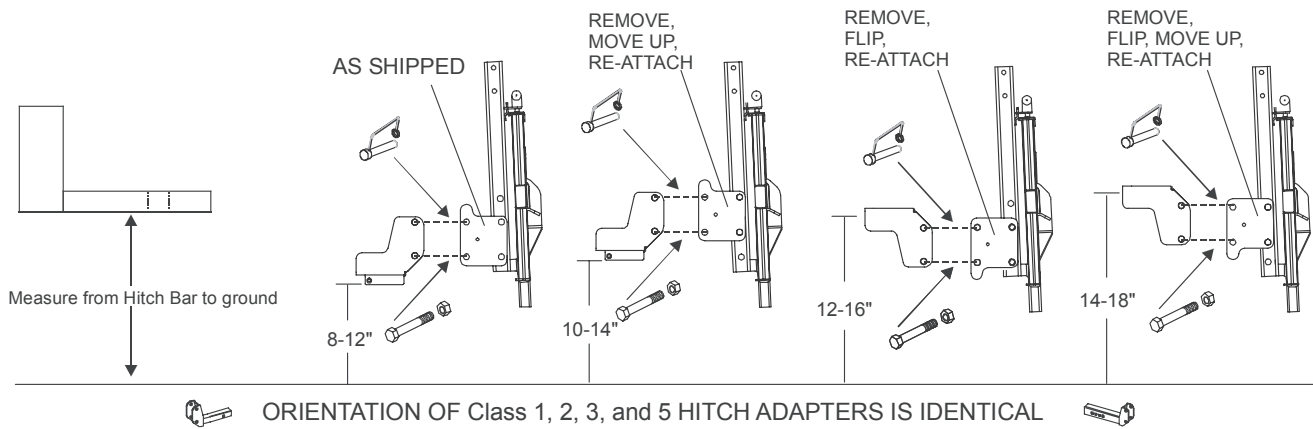

NOTE: If inverting/flipping the ball mount for better height, the ball mount and swing brackets must be flipped together. *See Figure 4-2.*

Orientation of these parts is important for the tilt away feature limits.

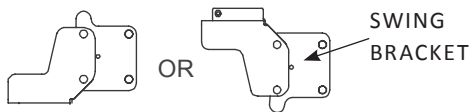
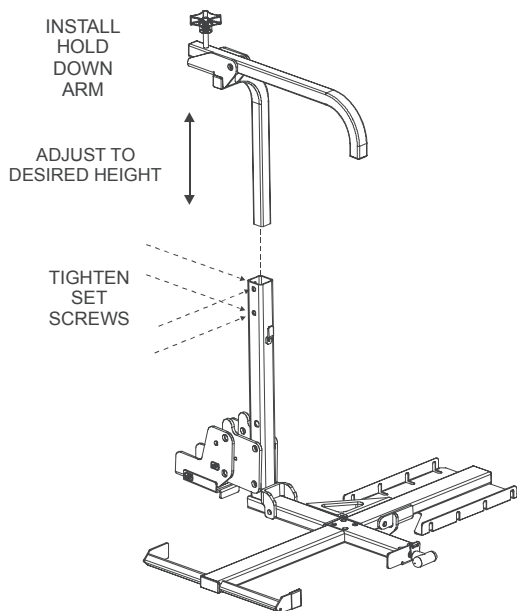

Figure 4-2

HOLD-DOWN ARM INSTALLATION



Hold-down arm height can be adjusted so that the wheelchair's armrests clear the hold-down arm when loading onto the tilted platform.

When the platform is tilted upright, the wheelchair should barely contact the bottom of the hold-down arm. *See Figure 4-3.*

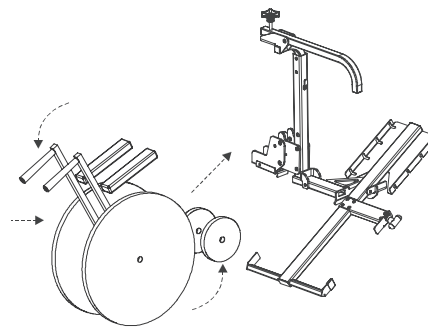

Figure 4-3

The knob on the hold-down arm can be turned to adjust the pressure on the wheelchair's armrest. *See Figure 4-4.*

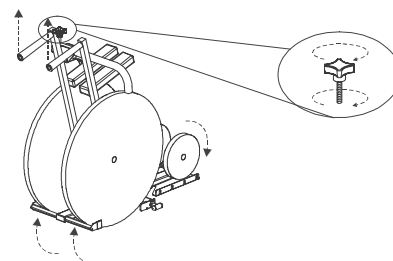

Figure 4-4

LOADING WHEELCHAIR

1. Pull up on the platform handle and hold the yellow handle. *See Figure 4-5.*

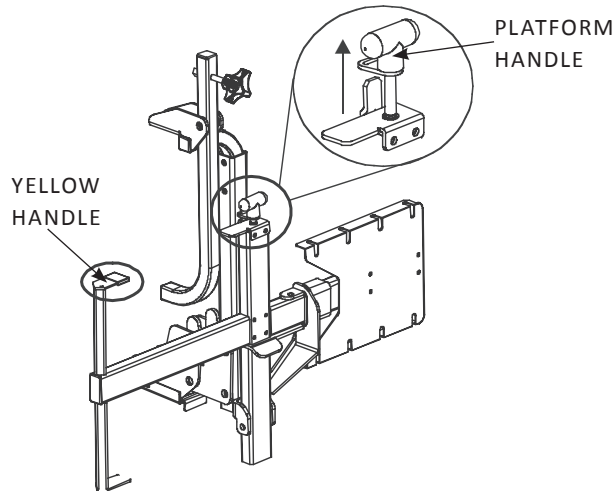

Figure 4-5

2. Lower the platform with the yellow handle while continuing to pull on the platform handle. *See Figure 4-6.*

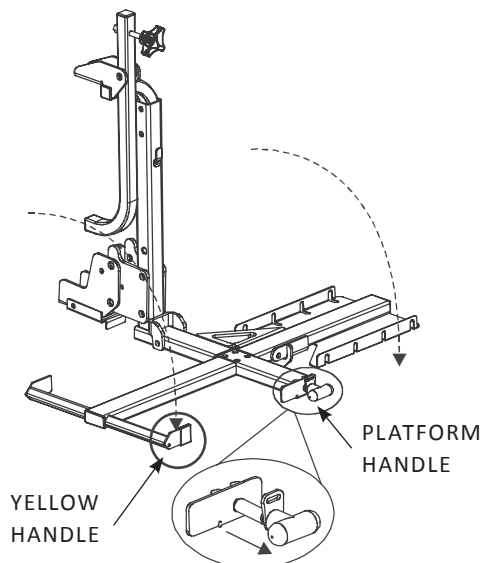

Figure 4-6

3. Tilt the platform to the ground. *See Figure 4-7.*

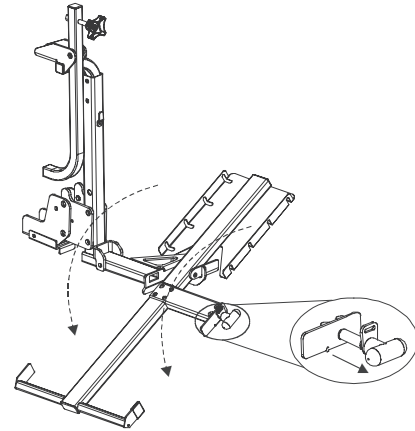

Figure 4-7

4. Flip the hold-down arm upright. *See Figure 4-8.*

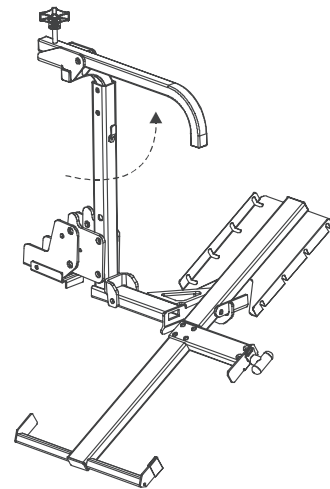

Figure 4-8

5. Push down on the wheelchair handles, tilting the smaller front wheels off the ground. Roll the wheelchair onto the platform. *See Figure 4-9.*

OPERATION

Figure 4-9

6. Once the larger wheels are seated in the platform cradle, pull up on the wheelchair handles. Once level, the platform will automatically latch into place. **See Figure 4-10.**

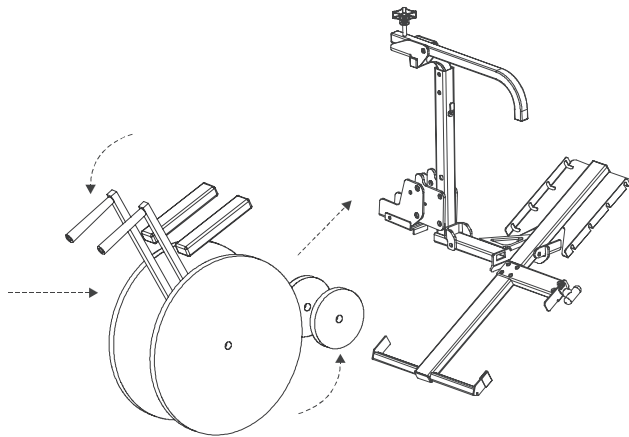
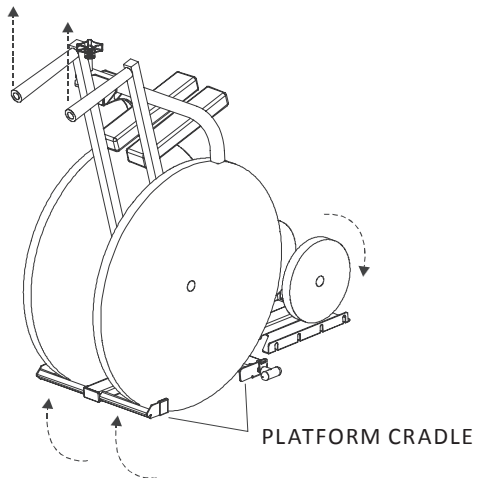

Figure 4-10

7. Tighten the hold-down arm against the wheelchair armrests by turning the knob on the hold-down arm clockwise. **See Figure 4-11.**

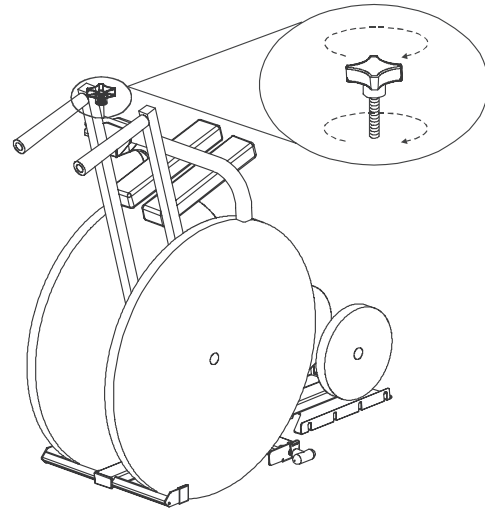

Figure 4-11

8. Your wheelchair is now ready for transport.

UNLOADING WHEELCHAIR

1. Release pressure off of the hold-down arm by turning the hold-down arm knob counter-clockwise. *See Figure 4-12.*

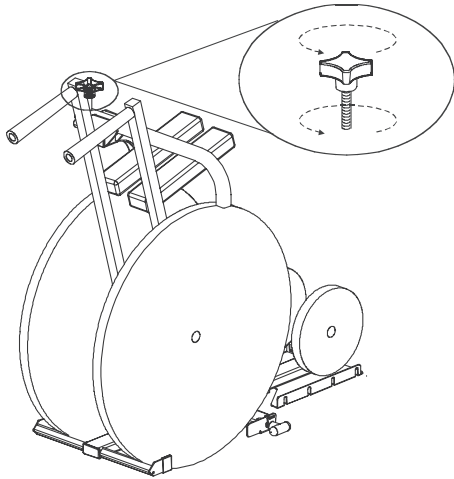

Figure 4-12

2. While holding the wheelchair up by the wheelchair handles, pull the platform handle out. Gravity will tilt the platform to the ground. *NOTE: Should the platform handle stick, lift up on the wheelchair slightly to release pressure off of the latching mechanism. See Figure 4-13.*

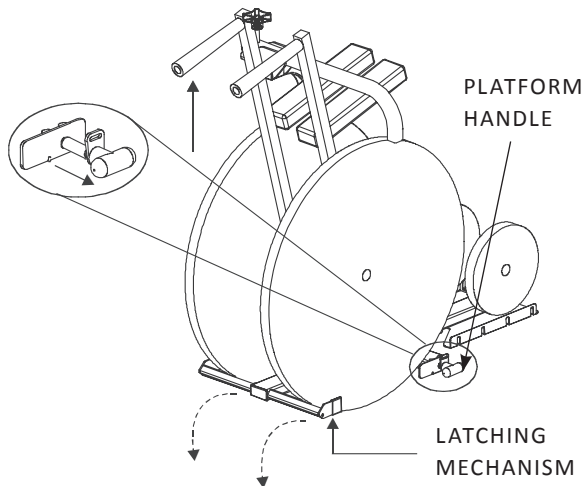

Figure 4-13

3. Push down on the wheelchair handles, tilting the smaller front wheels off of the platform. Roll the wheelchair off of the platform and rest all four wheels on the ground. *See Figure 4-14.*

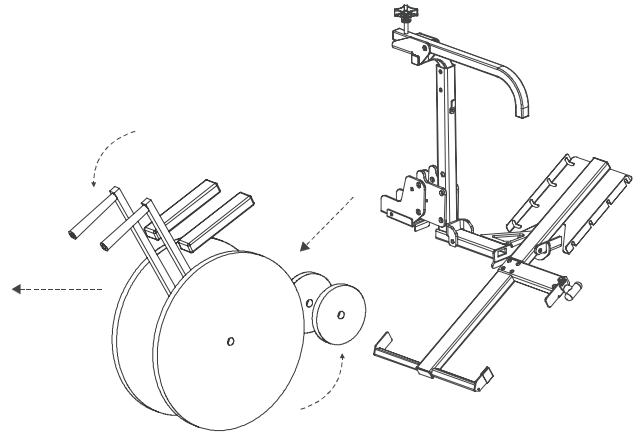

Figure 4-14

4. Fold the hold-down arm down. *See Figure 4-15.*

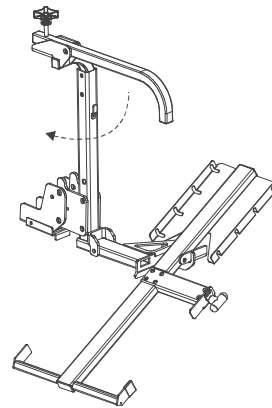

Figure 4-15

5. Push down on the front of the platform or pull up on the yellow handle to rotate the platform level. The platform will automatically latch into place. *See Figure 4-16.*

OPERATION

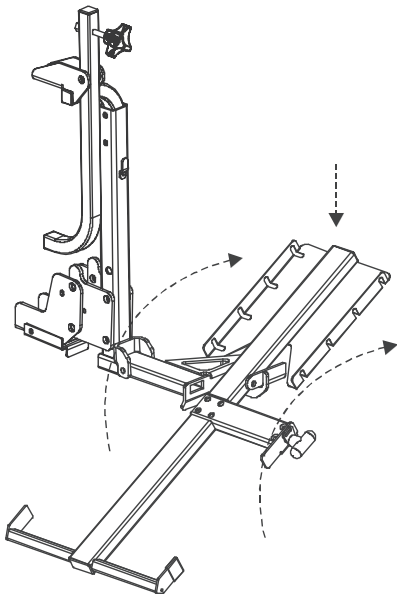

Figure 4-16

6. Lift the platform upright. *See Figure 4-17.*

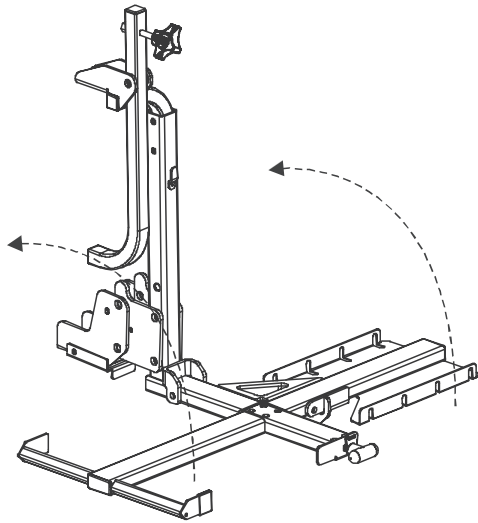

Figure 4-17

7. Pull up on the platform handle and place the keeper slot onto locking tab. *See Figure 4-18.*

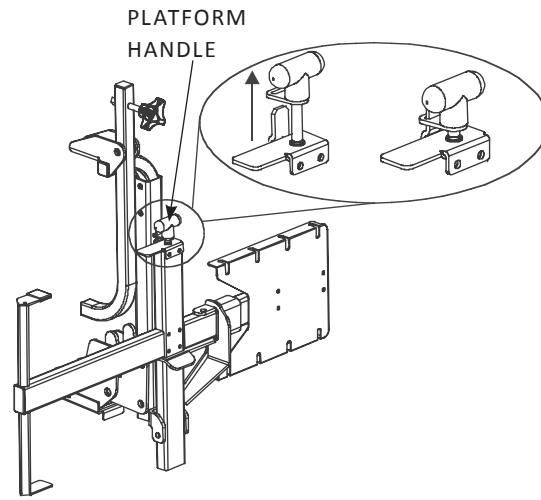

Figure 4-18

TILT AWAY FEATURE

The tilt away feature allows for easy access to the rear of the vehicle.

1. With the platform in the upright position, unhook the pin retainer and remove the hitch pin while bracing the AL003. *See Figure 4-19.*

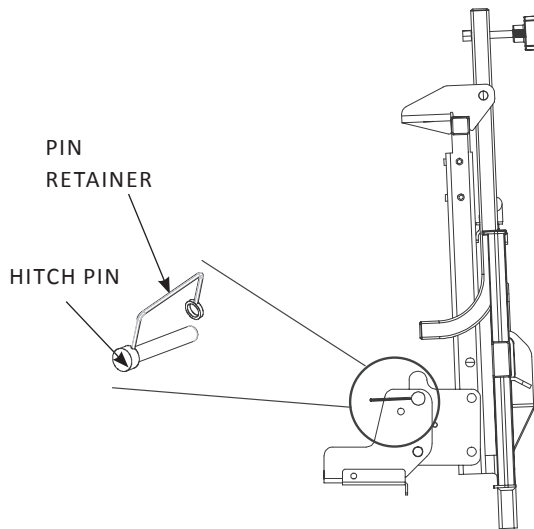

Figure 4-19

2. With the hitch pin removed, carefully lower the AL003 until it cannot be lowered any further. *See Figure 4-20.*

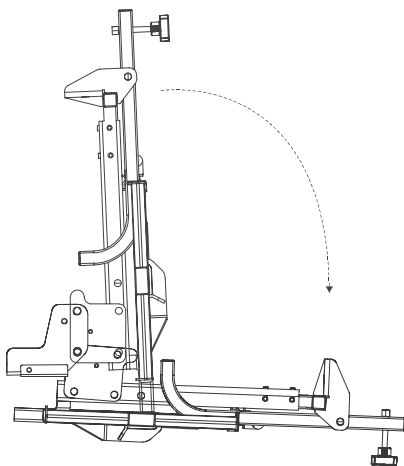

Figure 4-20

3. To get the lift back in the upright position, simply lift the AL003, align the holes for the hitch pin, and replace the hitch pin. Be sure to secure the hitch pin with the pin retainer.

WARNING

Never attempt to transport with the AL003 in the tilted down position.

SECTION 6 **MAINTENANCE**

- Every 6 months oil or grease the pivot points on all moving parts
- Check for paint chips and touch up any bare metal with a good black enamel or lacquer to inhibit rust. This may be necessary more frequently when subjected to salt air or road salt.

SECTION 7

TROUBLESHOOTING

PROBLEM	POSSIBLE CAUSE	SUGGESTIONS
<ul style="list-style-type: none"> Hold-down arm will not stay upright or is difficult to move. Platform is difficult to move. 	Improper adjustment at pivot points.	Tighten or loosen bolts until hold-down arm or platform operates smooth with some resistance.
The platform handle is hard to pull.	Lack of lubrication.	A lubricating spray (WD-40) will loosen the linkage to the platform latch. Lift up slightly on the platform to release pressure on the release latch.
<ul style="list-style-type: none"> The lift does not reach the ground when completely lowered. Lift bottoms out while entering driveways or going over bumps. 	<ul style="list-style-type: none"> Wrong ball mount or hitch adapter position Wrong hitch adapter 	Check the connection of the swing bracket to the outer tube. Normal range of operation is 8" - 12", measured from the bottom of the flat hitch bar or the bottom opening of the hitch receiver to the ground. Taller vehicles require drop hitch adapters, which can be obtained from an authorized Harmor dealer. Lift should be installed at the highest adjustment point possible.

WARRANTY

SECTION 7 3-YEAR TRANSFERABLE WARRANTY

The lift came with a separate warranty form on page 17. To register the lift, the warranty form must be returned within ten (10) days of installation. This warranty policy page must remain in the owner's manual for future reference. Do not tear out this page.

Dealer/Installer Name: _____

Address: _____

Phone: _____

E-Mail: _____

The installation date and serial # of the lift will be required for the dealer to receive factory information for service or warranty work.

Installation Date: _____

Serial # of the Lift: _____

Harmar Mobility warrants its lift products against defects in material, mechanical and electrical component (parts), excluding labor costs, batteries, paint and covers, for a period of three (3) years from date of retail purchase, provided that the products have been installed, maintained and operated properly. This warranty does not cover defects in vehicles on which Harmar products are installed or defects in Harmar products caused by defects in any part of the vehicle upon which the product is installed. This warranty does not cover maintenance or adjustments. Harmar will not be charged for labor, consequential damage or repair expenses. Harmar will not, under any circumstances, be liable for the loss of the use of its products or loss of time. This warranty becomes null and void if the product has been lost, damaged by accident, over stressed, misused and/or neglected, or if the product has been modified in any way. Defective parts must be returned, prepaid, to Harmar at the address listed above, for inspection prior to credit, repair or replacement, at Harmar's option. Harmar's sole obligation and the exclusive remedy under this warranty is limited to such credit, repair or replacement.

THIS EXPRESS WARRANTY IS IN LIEU OF ALL OTHER WARRANTIES OR CONDITIONS, INCLUDING ALL IMPLIED WARRANTIES OR MERCHANTABILITY OR FITNESS FOR A PARTICULAR PURPOSE, AND THERE ARE NO WARRANTIES THAT EXTEND BEYOND THE DESCRIPTION OF THE LIMITED WARRANTY DESCRIBED HEREIN. THIS WARRANTY GIVES YOU SPECIFIC LEGAL RIGHTS AND YOU MAY ALSO HAVE OTHER LEGAL RIGHTS WHICH VARY FROM STATE TO STATE.

PLEASE FILL OUT ALL FIELDS AND RETURN WITHIN TEN (10) DAYS OF PRODUCT INSTALLATION.

Fax completed form to 1-866-234-5680 or mail to:
Harmar, ATTN Warranty Department, 1500 Independence Blvd., Suite 220, Sarasota FL 34234.

PRODUCT INFORMATION

Model: _____
Serial Number: _____
Purchase Date: _____
Installation Date: _____

INSTALLER INFORMATION

Company Name: _____
Contact Name: _____
Address: _____

Phone: _____
Fax: _____
Email: _____

APPLICATION INFORMATION

Scooter Power Wheelchair
 Wheelchair N/A
Year: _____
Manufacturer: _____
Model: _____

PURCHASER INFORMATION

Name: _____
Address: _____

Phone: _____
Email: _____

ADDITIONAL INFORMATION

How did you hear about Harmar?

- Harmar Dealer
- Internet
- Magazine
Which: _____
- Friend or Acquaintance
- Saw Harmar product somewhere
- Other: _____

I purchased my Harmar lift because of:

- Style/Appearance
- Harmar Representative
- Previous Experience
- Ease of Use
- Recommendation
- Price/Value



WARRANTY

Page Intentionally Left Blank





1500 Independence Blvd., Ste 220
Sarasota, FL 34234
800.833.0478
harmar.com